

MFG

Metal Front Guard for P-IX Platform

Installation:

Step 1

Lift up the P-IX left side frame

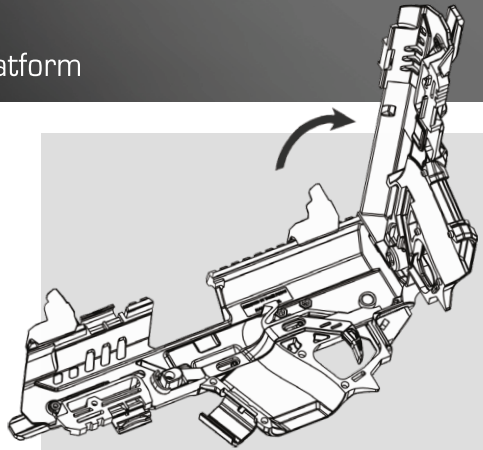

Step 2

1. Place the Metal Front Guard on the nub located on the right polymer frame.

2. Insert the screw through the oval opening on the right polymer frame.

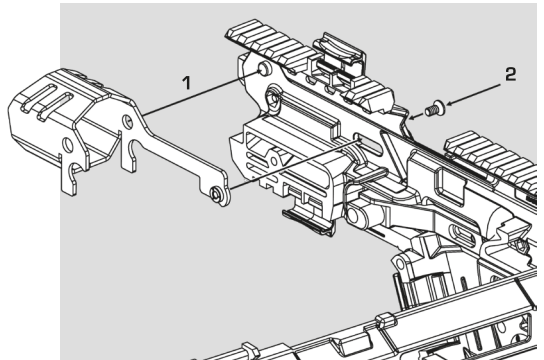

Step 3

Tighten the screw onto the back thread of the metal front guard with supplied Allen key.

