



* NOT COMPATIBLE WITH GEN.4

* LIMITED TO AN OPTIC WEIGHT OF 100 g / 3.5 oz



FEATURES

- ALLOWS FOR A MORE ERGONOMIC CHARGE OF YOUR GUN.
- ALLOWS FOR MOUNTING A RED DOT AND OTHER PICATINNY RAIL ACCESSORIES*
- NO PROTRUDING PARTS TO SNAG ON CLOTHES OR HOLSTERS.
- SIMPLE INSTALLATION.
- WON'T DAMAGE YOUR FIREARM.

SPECS

- WEIGHT: 24G.
- GLASS REINFORCED POLYMER.

INSTALLATION

- SAFETY CHECK YOUR GUN.
- LOCK YOUR SLIDE TO THE REAR.
- ALIGN THE LOWER AND UPPER PARTS OF THE CHARGING HANDLE WITH SLIDE SERRATIONS AND DROP INTO PLACE.
- SECURE WITH SUPPLIED HARDWARE.

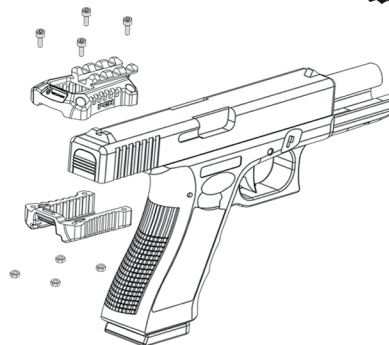

PCH

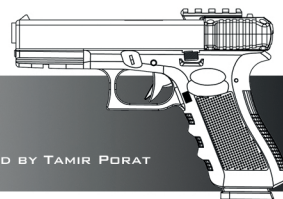

DESIGNED BY TAMIR PORAT

IF YOU HAVE ANY QUESTIONS, COMMENTS
OR CONCERNS PLEASE CONTACT US AT:



SERVICE@RECOVERTACTICAL.COM

PICATINNY CHARGING HANDLE FOR GLOCK